

# ME80 - 100 - 112 - 132

**Motori C.C. in derivazione alim. da batteria - Potenza da 0.38kW a 14kW**  
**Shunt field D.C. motors battery supply - Power from 0.38kW to 14kW**

## CARATTERISTICHE PRINCIPALI

- Motori C.C. a norme CEI ed IEC.
- Eccitazione separata.
- Poli ausiliari su tutte le grandezze.
- Tensione armatura 12V ÷ 110V.
- Protezione IP23 - servizio continuo S1.
- Autoventilati IC01.
- Scatola morsetti o fili uscenti.

## MAIN FEATURES

- D.C. motors according to CEI and IEC standards.
- Shunt field.
- Interpoles on all sizes.
- Armature voltage 12V ÷ 110V.
- IP23 protection - continuous duty S1.
- Self ventilated IC01.
- Terminal box or free wires.



Tipo / Type	ØAC	L	Potenza a / Power at			
			1400/1600rpm	1800/2200rpm	2300/2700rpm	2800/3200rpm
ME80R	157	285	0.38 kW	0.5 kW	0.65 kW	0.75 kW
ME80S	157	305	0.5 kW	0.7 kW	0.8 kW	1 kW
ME100R	192	310	0.65 kW	0.8 kW	1 kW	1.3 kW
ME100S	192	330	0.9 kW	1.2 kW	1.5 kW	1.7 kW
ME100T	192	330	1.1 kW	1.4 kW	2 kW	2.6 kW
ME112R	220	335	1.7 kW	2.2 kW	2.5 kW	3.2 kW
ME112S	220	335	2.3 kW	2.7 kW	3.2 kW	4 kW
ME112T	220	375	2.5 kW	3.3 kW	4 kW	4.7 kW
ME112L	220	405	2.8 kW	3.8 kW	4.5 kW	5.5 kW
ME132R	260	390	3.7 kW	5.2 kW	6.2 kW	8 kW
ME132S	260	415	4.8 kW	6.4 kW	7 kW	9 kW
ME132T	260	440	6 kW	8 kW	9 kW	10 kW
ME132L	260	480	8 kW	10 kW	12 kW	14 kW

DATI PROVVISORI. Richiedere aggiornamento in fase di scelta del prodotto/ PROVISIONAL DATA. Contact us for the updates

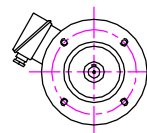
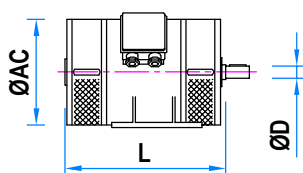
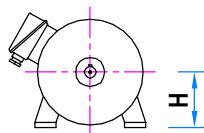

IEC B5	IEC B14
71	-
80	-
90	-
100	100
112	112
132	132

Tipo / Type	ØD	H
ME80	14-16-19	80
ME100	19-24	100
ME112	24-28	112
ME132	28-38	132

## OPZIONI :

- Flange e alberi speciali
- Freno di sicurezza esterno
- Protezione IP54 o IP55

## OPTIONS :

- Special shafts and flanges
- External safety brake
- IP54 or IP55 protection